

DUFOUR

YACHTS

PRESS RELEASE JULY 2011



New • Nouveau • Neu • Nuovo • 335 • Nuovo • Nouveau • Neu • New

DUFOUR | 335
Grand Large



DUFOUR | 335
Grand'Large

SUMMARY

INTRODUCTION *STYLE & DARING – Dufour thinks out the cruising codes.*

DUFOUR 335 *Grand'Large* *AN UNCOMMON STYLE*

A. *Sail another way*

1. *Daring and wide cockpit.*
2. *Ideal ergonomics for easier manoeuvring.*
3. *High degree of autonomy.*

B. *Live serenely on board*

1. *A boat made for live in.*
2. *A definitely modern style.*

SYNTHESIS

1. *Outdoor and indoor layouts*
2. *Technical characteristics.*

CONTACT *DUFOUR YACHTS*





DUFOUR | 335
Grand'Large

INTRODUCTION

STYLE & DARING – Dufour thinks out the cruising codes.

For more than 40 years, Dufour Yachts combines innovation and passion with talent, offering an unequalled sailing experience.

This year, the *Grand'Large* range counts with a **new daring 33'**:

DUFOUR | 335
Grand'Large

A suite of innovations for unique sailing sensations..

The new *Grand'Large* 335 gathers all the successful advantages of its big brother 375: SPACE, ERGONOMICS and COMFORT.

Designed for long cruising, it stands out by a surprising organization and comfort for a boat of this size.

An amazing creation, designed by Umberto FELCI for DUFOUR YACHTS, to be discovered exclusively on the fall boat shows.



DUFOUR | 335
Grand'Large

AN UNCOMMON STYLE...

GENERAL PRESENTATION





GENERAL PRESENTATION

A. SAIL ANOTHER WAY

Dufour 335 *Grand'Large* offers an incredible freedom of sailing thanks to 3 innovative solutions:

1. Daring and **wide cockpit.**
2. Ideal **ergonomics** for easier manoeuvring.
3. High degree of **autonomy.**





DUFOUR | 335
Grand'Large

GENERAL PRESENTATION

AN UNCOMMON STYLE...



1. Daring and wide cockpit

DUFOUR YACHTS designed an extremely wide open cockpit for a boat of this size.

This open space is very functional and provides a lot of sailing emotions :

- Wide visibility
- Free movements on the roof:
 - No backstay
 - Shroud U-rings fixed outside of the hull / Low shroud u-rings fixed on the roof borders.
- Fast access inside the boat.



DUFOUR | 335
Grand'Large

AN UNCOMMON STYLE...

GENERAL PRESENTATION



2. Easy maneuvering

The layouts of the deck and the cockpit were designed to facilitate handling and keep the pleasure of sailing.

- **Double steering wheels** reas box
- Articulated U-rings for different sheet positions.
- Genoa128° = easier tack.
- Asymmetrical spinnaker with boom sprit.
- Removable cockpit table with possible GPS like on our bigger boats (+ 50').

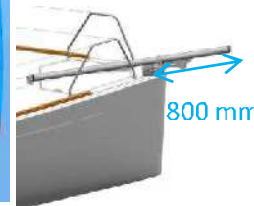
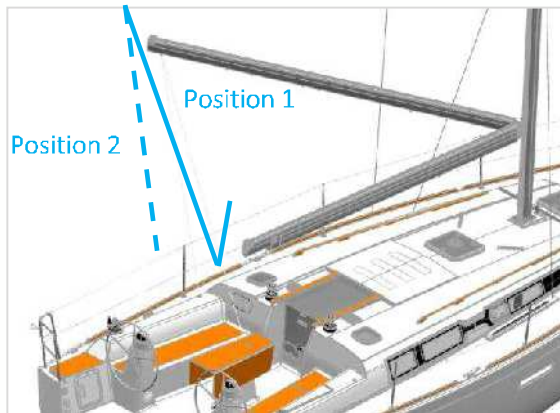



GENERAL PRESENTATION

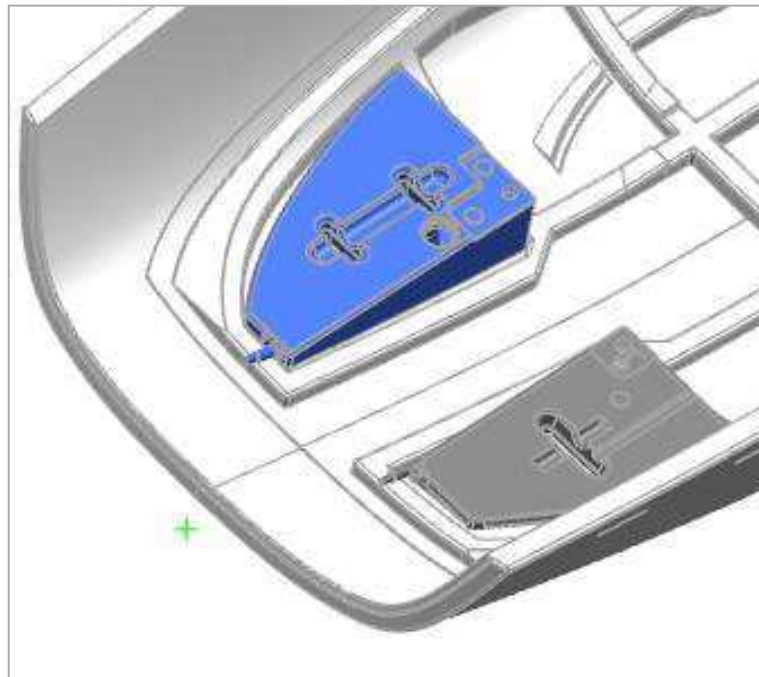

3. High degree of autonomy

The 335 GL allows to navigate serenely several days thanks to a high autonomy in fuel and water.

- Water tank 47.27 gallons + additional tank 34.37 gallons (option)
- Fuel tank 34.37 gallons.
- Water heater 4.4 gallons





GENERAL PRESENTATION

B. LIVE SERENELY ON BOARD

At mooring or cruising, the Dufour 335 *Grand'Large* offers a rare comfort on the boats of this size.

1. A **boat made for live in.**
2. A definitely modern **style.**

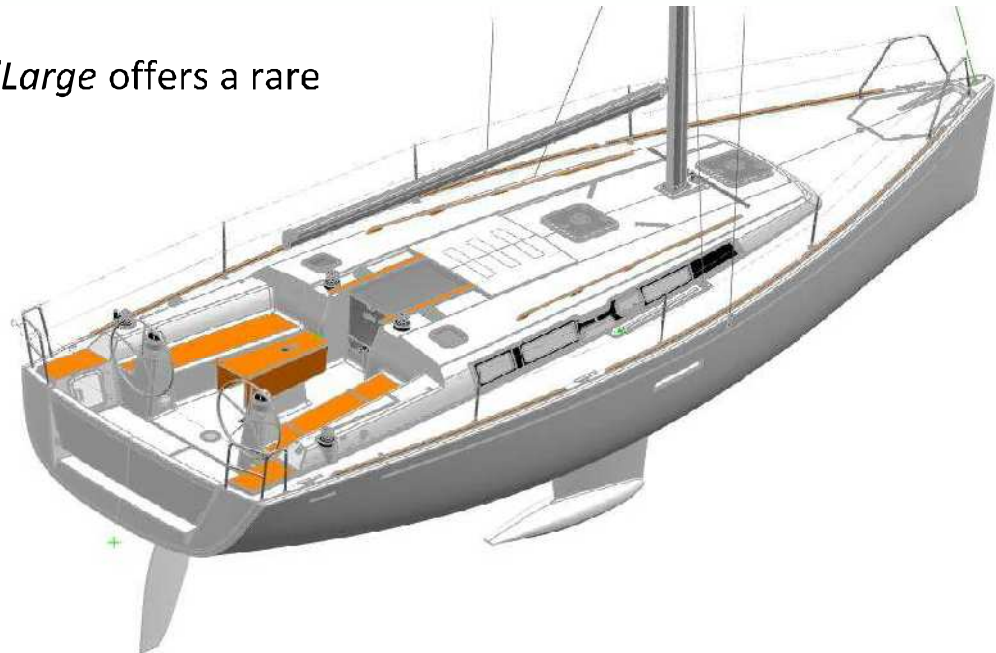



DUFOUR | 335
Grand'Large

AN UNCOMMON STYLE...

GENERAL PRESENTATION



1. A boat made for live *... outside at mooring*

The outside layout of the deck has been specially designed to simplify the mooring and take advantage of an easy access to the sea.

- **A wide stern deck** to enjoy swimming.
- The cockpit becomes a place to live as pleasant as on the taller boats.



DUFOUR | 335
Grand'Large

AN UNCOMMON STYLE...

GENERAL PRESENTATION

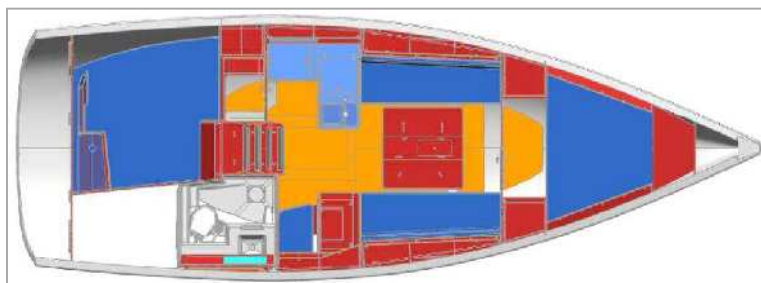

2. A boat made for live

...inside in an elegant cheerful place.

A lot of space, functional layouts and noble fabric make the 335 a boat unique to live in.

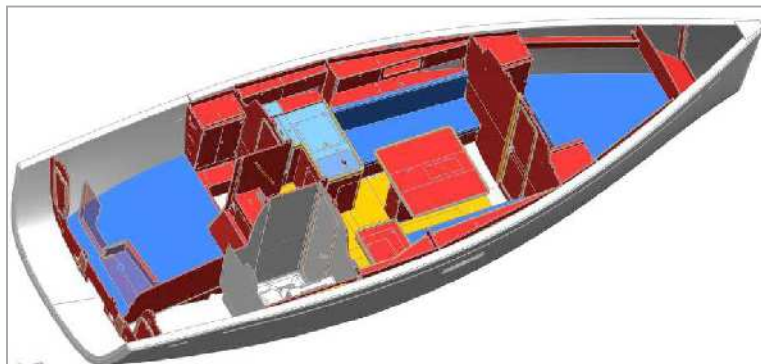

- 2 wide cabins.
- Ergonomic and luminous saloon.
- Functional kitchen(bottles storage, garbage sorting, wine cellar...)
- Spacious bathroom.



DUFOUR | 335
Grand'Large

GENERAL PRESENTATION

AN UNCOMMON STYLE...



3. A definitely modern style

335 GL is keeping with modernity thanks to an innovative design and high technical equipment.

Efficient on the sea, pleasant and elegant, the 335 gives new cruising prospects.



DUFOUR | 335
Grand'Large

EN SYNTHÈSE





OUTSIDE LAYOUT

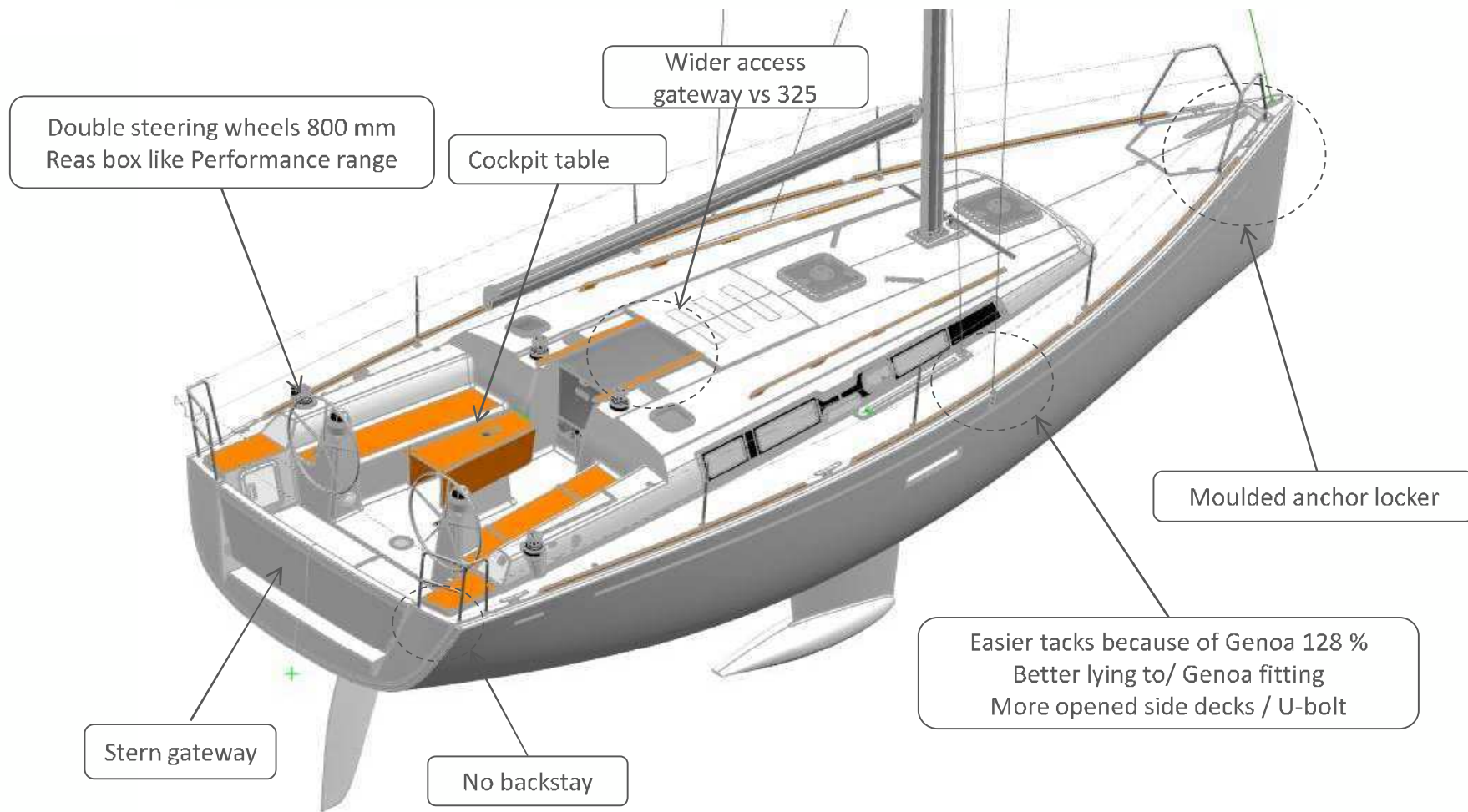



INSIDE LAYOUT

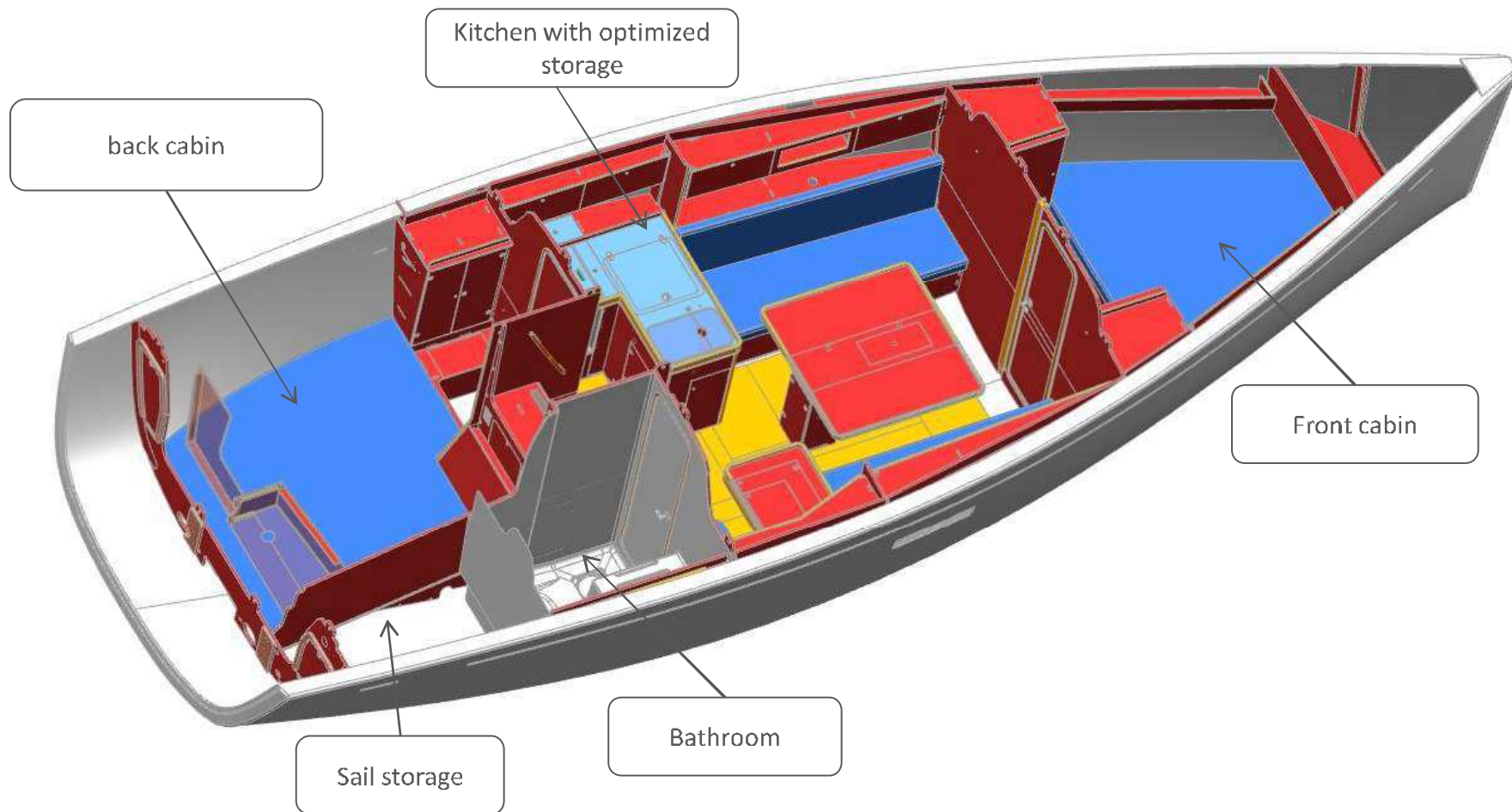



CARACTERISTIQUES TECHNIQUES

DESIGNATIONS	335
Overall length*	33.73 ft
Hull length	32.74 ft
Waterline length	29.53 ft
Beam length	1.145 ft
Light displacement deep keel	12,015 lbs
Deep keel	6.23 ft
Deep keel weight	3,417 lbs
Fresh water tank capacity + additional water tank (option)	47.27 gallons 34.37 gallons
Fuel tank capacity	34.37 gallons
Engine	20 HP
Architect-designer	Umberto FELCI



* 32.74 ft (removable davit)



PLAN DE VOILURE

- Mainsail surface area: 312.15 sq ft
- Genoa surface area 128% : 269.09 sq ft
- Total surface area: 581.25 sq ft

